



K-Ultra Manual Coffee Grinder

1ZPRESSO.COM



Expanded View



Acrylic lid

Knurled Thumb Nut

Upper Bearing Cap

Upper Bearing

Crank Knob

Foldable handle
Push up to fold

Adjustment Dial Ring

Body

Anti-Slip Silicone
Leather
The illustration is for reference only. The actual color may vary.

Burr Ring Unit

Central Shaft

Spring

Lower Bearing Cap

Burr

Receiver

Grounds Capacity: 35-40g (depending on the bean type)

User Instructions



Dial Pointer



Adjustment Dial Ring

1. Turn the adjustment dial to dial into your preferred grind settings. The dial pointer indicates the grind setting; the bigger the number, the coarser the grind size.
2. There are 100 clicks in an entire rotation with a maximum total of 1.5 rotations. Each rotation moves the burr by 2mm, and each click moves the burr by 0.2mm/20 microns.
3. After reassembling the grinder, ensure the adjustment dial is calibrated correctly according to the calibration guide below.
4. Please refer to the Grind Setting Reference Chart for different brewing methods.
5. Pour the beans into the hopper from the top and turn the handle clockwise to start grinding.



Video instructions for disassembly and assembly are available on our website:

<https://1zpresso.coffee>

or our official YouTube channel: 1Zpresso.

Disassembly

Note: Please follow the tutorial step by step.



1. Turn the **adjustment dial** clockwise to coarser grind settings as the burrs open up.



2. Loosen the **knurled thumb nut** counter-clockwise while pushing the **burr** and take out the **upper bearing cap** and the **upper bearing**.

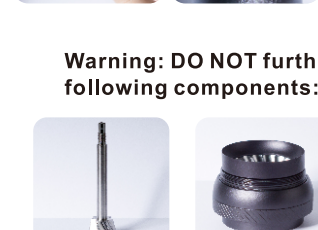

3. Take out the **shaft**, **burr**, **lower bearing cover** and **spring**.



4. Remove the **burr ring unit** and the **adjustment dial** clockwise from the grinder.

5. Clean each of the parts with a brush and an air blower.

Warning: DO NOT further disassemble or remove the following components:



Central shaft and inner/conical burr



The burr ring unit and outer burr

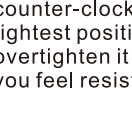

The adjustment dial ring

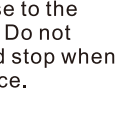

The bearings attached to the upper shaft chamber

Assembly



1. Turn the **adjustment dial** counter-clockwise to the tightest position. Do not overtighten it and stop when you feel resistance.



2. Turn the **adjustment dial** clockwise to coarser grind settings.

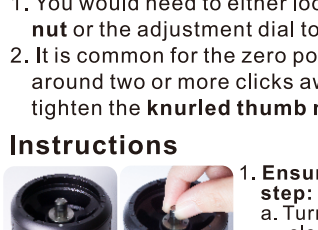

3. Turn the **burr ring unit** counter-clockwise to the tightest position. Do not overtighten it and stop when you feel resistance.



4. Put the components back in the right sequence: **lower bearing cap** (the raised edge side facing upward), **spring**, **shaft** and **burr**.



5. Put the parts back in the right sequence while pressing the burr: **upper bearing**, **upper bearing cap** (the concave edge of the cap facing upward and ensure to put the upper bearing cap back in the correct direction).

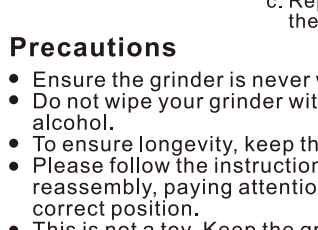

6. Turn the **knurled thumb nut** clockwise while pushing the **burr** and stop when you feel resistance.

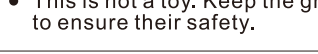

7. Turn the **adjustment dial** to the zero setting and see if the indicator aligns with #0. Read the calibration guide below if it is not aligned with #0.

Calibrating the Adjustment Dial

1. You would need to either loosen or tighten the **knurled thumb nut** or the adjustment dial to calibrate the grinder.
2. It is common for the zero point of the **adjustment dial** to be around two or more clicks away due to the strength you use to tighten the **knurled thumb nut**.

Instructions

1. **Ensure to calibrate the grinder step by step:**
a. Turn **adjustment dial/ring** counter-clockwise to the zero/tightest settings.
b. Ensure the **central shaft** is not loose nor installed incorrectly.
c. The grinder is well-calibrated if the dot is at #0 when the **adjustment dial ring** is at its tightest position. Read the following steps for calibration if you don't get #0 for the zero setting.

2. **If the Dial Pointer is pointing at the right side of #0:**
a. Turn the **adjustment dial ring** clockwise to coarser setting as the gap **inside the adjustment dial ring** enlarges.
b. Loosen the **knurled thumb nut** counter-clockwise a little bit while pressing the burr from the bottom. Turn the **adjustment dial ring** counter-clockwise back to its zero settings and see what number (#) the Dial Pointer points at.
c. Repeat this step or the next step until the grinder is calibrated.

3. **If the Dial Pointer is pointing at the left side of #0:**
a. Turn the **adjustment dial ring** counter-clockwise to a coarser setting as the gap **inside the adjustment dial ring** enlarges.
b. Tighten the **knurled thumb nut** clockwise a little bit while pressing the burr from the bottom. Turn the **adjustment dial ring** counter-clockwise back to its zero settings and see what number (#) the Dial Pointer points at.
c. Repeat this step or the step above until the grinder is calibrated.

Precautions

- Ensure the grinder is never washed or cleaned with water.
- Do not wipe your grinder with solvents other than water and alcohol.
- To ensure longevity, keep the grinder in a dry location.
- Please follow the instructions properly for disassembly and reassembly, paying attention to the order of parts and their correct position.
- This is not a toy. Keep the grinder out of reach of young children to ensure their safety.